

BHARTIYAM RESTAURANT

ALL THE STANDS IN THIS HALL SHOULD HAVE ENTRY EXITS ON ALL THE VISIBLE SIDES FACING PASSAGES & TRANSPARENTLY IN THE PARTITIONS SHOULD BE MAINTAINED. THE DESIGN OF THE STAND SHALL BE GOT APPROVED FROM ARCHITECTURE DEPARTMENT BEFORE START OF THE STAND CONSTRUCTION.

TRIPITY RESTAURANT

ITF - 2015

HALL 6 (GROUND FLOOR PLAN)

HALL SPECIFICATION	BROAD CATEGORIES OF PRODUCTS
JHARKHAND, PUDUCHERRY, GOA, CHANDIGARH, RAILWAYS & GOVT. DEPT.	

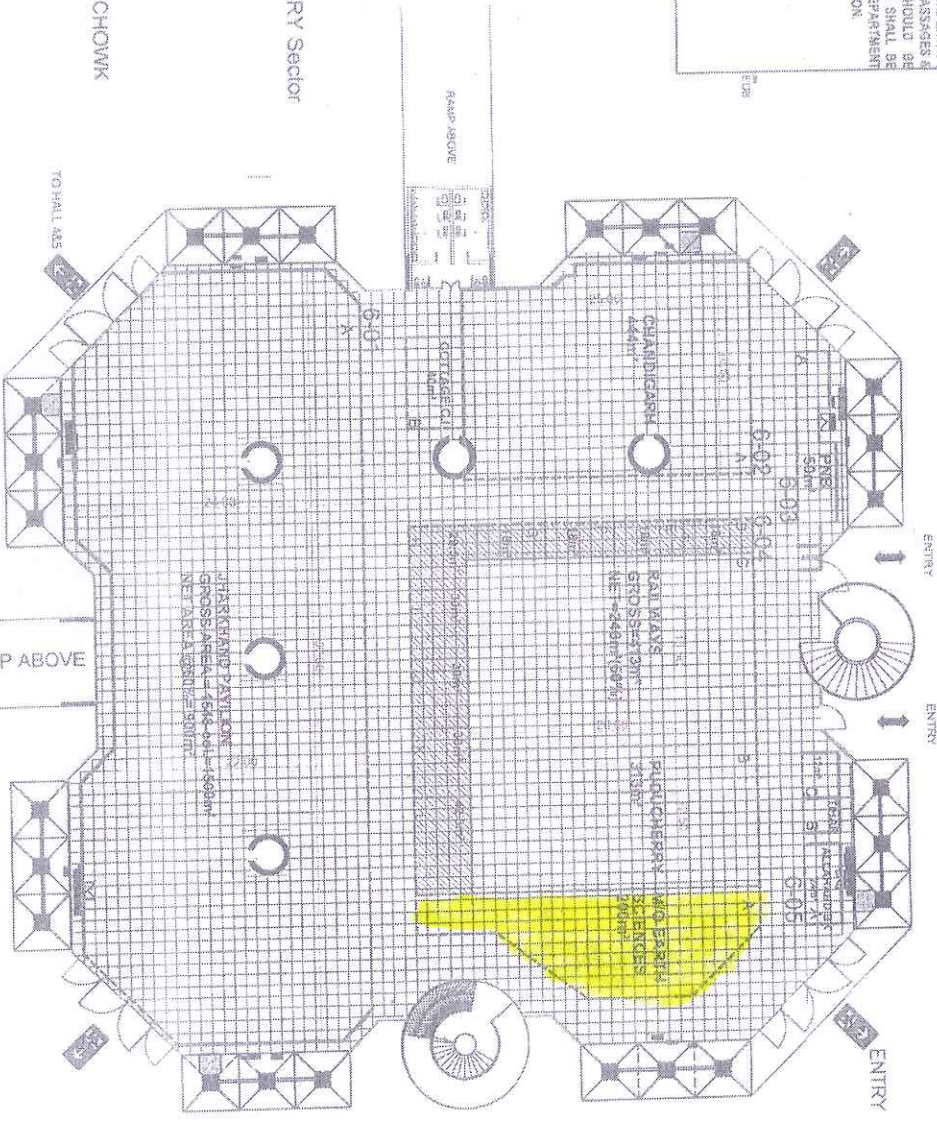

LEGEND:

	ELECTRICAL PANEL
	HOSE REEL - 4
	EMERGENCY LIGHT - 4
	EMERGENCY EXIT - 4
	MANUAL CALL POINT - 4
	LARGE HOLLOW COLUMN
	ENTRY/EXIT/REMARK EXIT

TENTATIVE PLAN

STATIONARY Sector
235m²

LAL CHOWK

TOTAL 485

RAMP ABOVE

PROJECT TITLE & KEY PLAN:
INDIA INTERNATIONAL TRADE FAIR
PRAGATI MAIDAN NEW DELHI

DATE: 15/01/2015
SCALE: 1:1000
DRAWING NO: ITP-2015-016
NORTH

NOTE:
THIS DRAWING IS THE PROPERTY OF IITF. IT SHALL BE USED ONLY FOR THE PURPOSE FOR WHICH IT HAS BEEN ISSUED BY THE ARCHITECTURE DEPARTMENT. AMENDMENTS IF ANY REQUIRED IN THE DRAWING PLAN SHALL BE APPROVED FROM ARCH. DEPT. CONSTRUCTION WITHIN THE ALLOTTED STALL. STALL SHOULD BE OPEN SPACE BY THE PARTICIPANTS. AMENDMENTS SHALL BE AS PER ARCHITECTURE & ENG. DEPARTMENT'S CONTROL OF WORK.
*USE OF STANDS ON THE RAMP SHOULD BE TO BE GOT APPROVED FROM ARCHITECTURE DEPARTMENT.

IITF INDIA TRADE PROMOTION ORGANISATION
ARCHITECTURE DEPARTMENT
PRAGATI MAIDAN, NEW DELHI.

REVISION	DATE OF ISSUE	SIGN OF ISSUING OFFR.

DR: SAHIL KASHI SHARMA
DESIGNER: REEKHA JAIN
ARCHITECT: ARVIND K. KAUR
BRILLIANT